

INSTALLATION INSTRUCTIONS

2022-2024 Honda Pioneer 1000-3, 1000-5, & 1000-6

PART #902409

**1 - Heat Shield
6 - Nylon push pins**

NOTES: On the 1000-6 model, the kit will go under the rear seat instead of the front seat. The install procedure is the same, but the shield gets installed under the rear seat.

SURFACE PREP:

Vacuum or wipe down installation area to remove all loose debris/dust.

TOOLS:

Use manufacturer's suggested tools for seat & panel removal

**INSTALLATION QUESTIONS? CONTACT DEI AT 800-264-9472
OR VIA EMAIL AT TECH@DESIGNENGINEERING.COM**

1. Remove lower front seat following factory instructions. Set aside (Fig 1)
2. Remove the under seat Center and passenger side tray's & driver side storage well. Driver side has push pins and one bolt in the bottom to remove. Passenger side has push pins holding it in place. (Fig 2)



FIG 1



FIG 2

3. Raise the rear bed using the release lever
(FIG 3)



FIG 3

4. Remove the 5 bolts holding the upper seat pad
in place using a 10mm socket and ratchet.
(FIG 4)



FIG 4

5. Lift the upper seat pad out and set aside.
(FIG 5)



FIG 5

6. You will need to remove the plastic panel shown in (FIG 6) (MARKED IN RED). This is held in place with two different styles of plastic push pins. For the style with the larger head, lift up on the center pin, then remove the complete push pin. (Image FIG 7 & FIG 8). The other style push pin has a small center pin that you push in using a small punch or screw driver. (FIG 9)

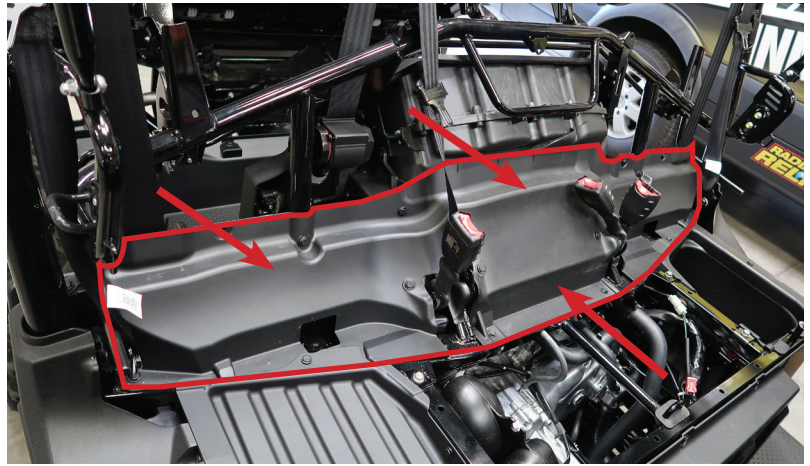

FIG 6



FIG 7

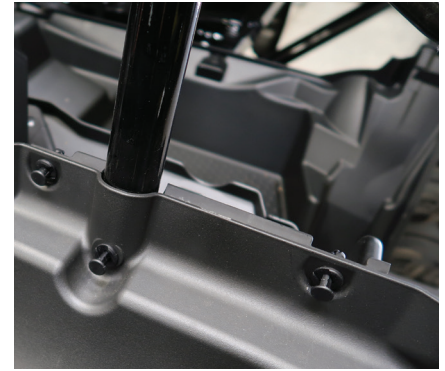

FIG 8



FIG 9

7. Remove the rear plastic shield and set aside. (FIG 10)



FIG 10

8. Remove vent tube from frame. This tube will be re-installed through a pre-cut hole in the heat shield. (FIG 11 & FIG 12)



FIG 11



FIG 12

9. The fuel line is located under the square tube cross bar of the frame. It is held in place by two clips. Leave the clips in place and unsnap the fuel line from the clips. The clips will protrude through pre-cut holes in the heat shield, and the fuel line will be re-installed. (FIG 13, FIG 14 & FIG 15)



FIG 13

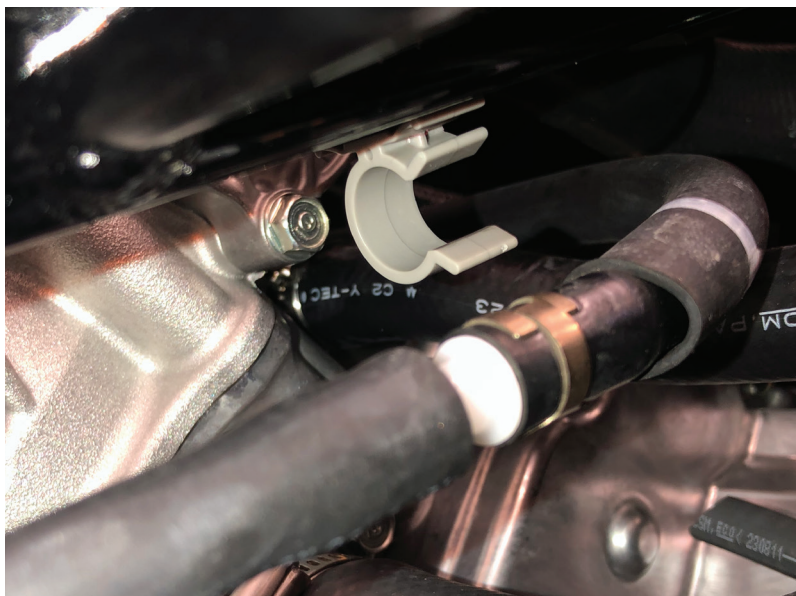

FIG 14



FIG 15

10. On driver side, remove the clip holding the coolant hose in place from the frame.
A clip will protrude through a pre-cut hole in the heat shield, and the coolant hose will be re-installed. (FIG 16)



FIG 16

11. Start to install heat shield with reflective side facing down. (FIG 17)

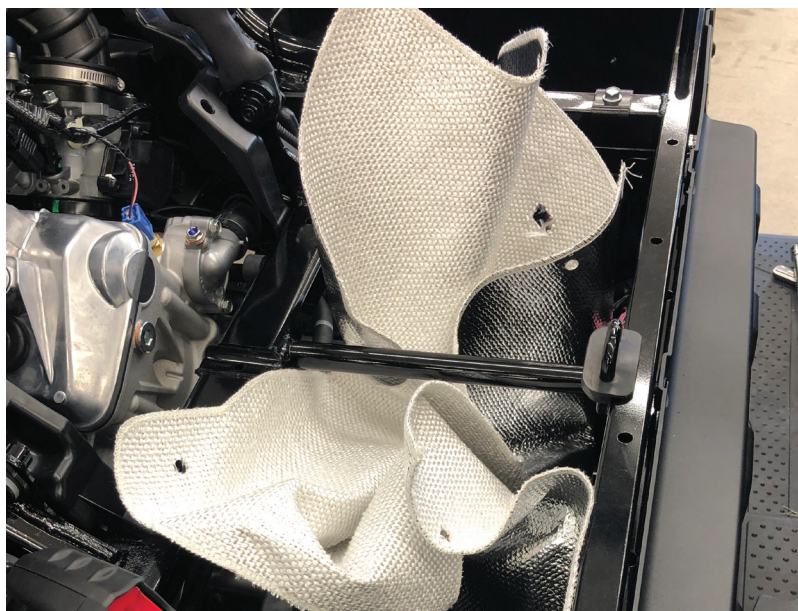
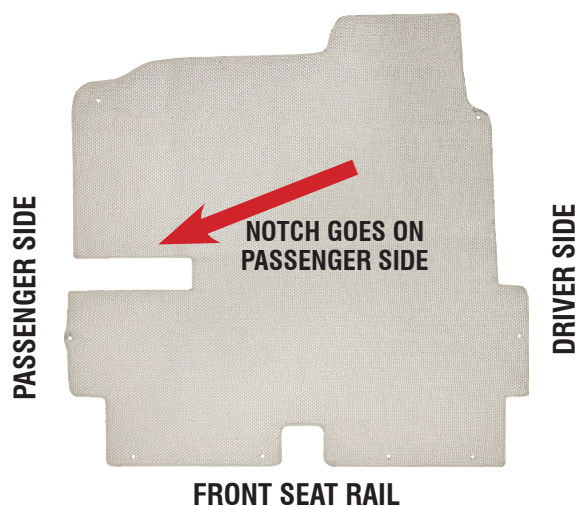

FIG 17

12. Line up the upper back portion of the heat shield. Before installing the bottom seat portion, line the fuel line clips up with the holes in the heat shield and re-install the fuel line into the clips. Repeat the process for the coolant hose. Line up the hole and re-install the clip. Feed the vent tube through the hole in the heat shield and re-install into the frame (FIG 18)



FIG 18

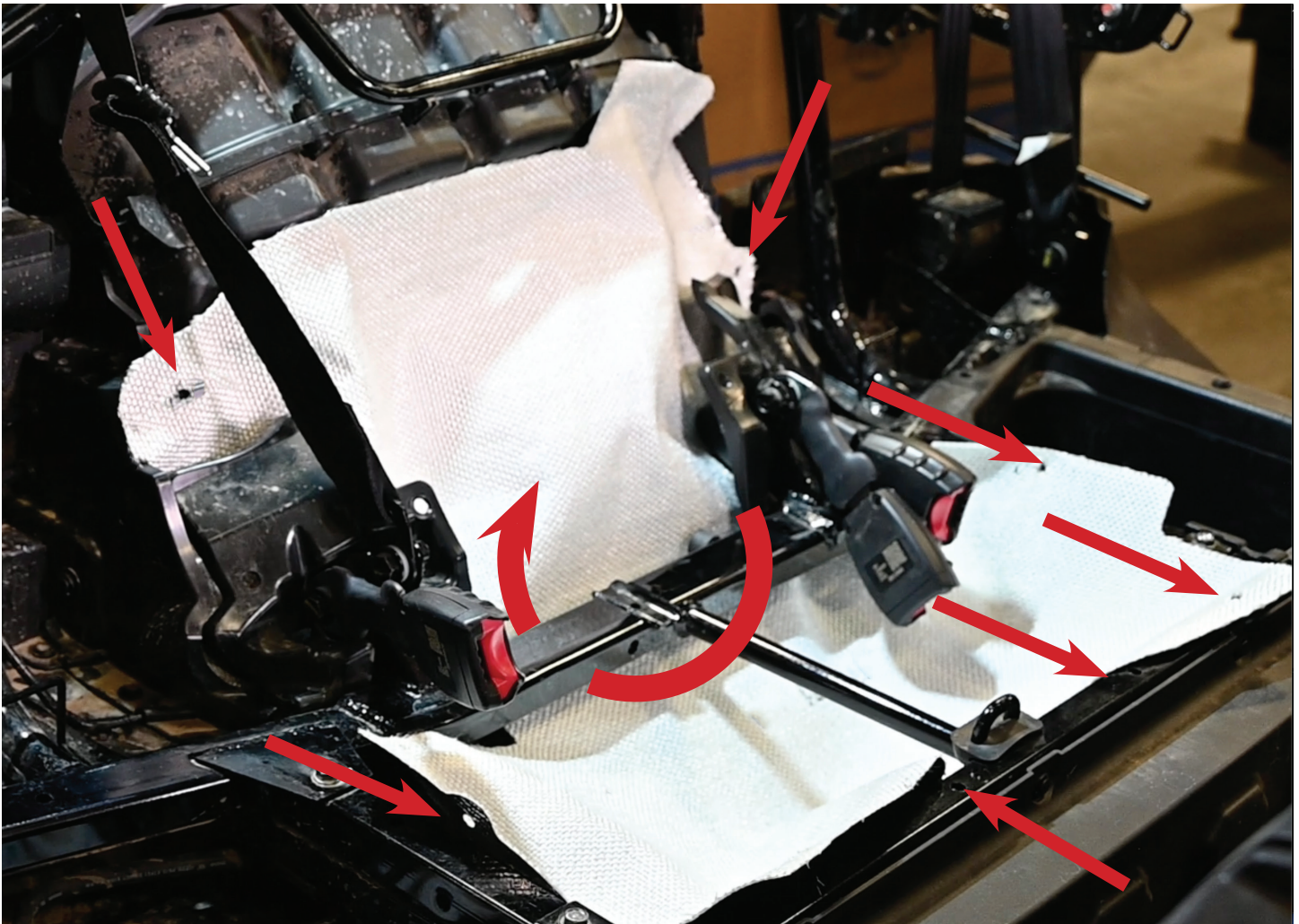

FIG 19

13. Align the holes in the heat shield with the existing holes where the plastic panel mounted (See red arrows on the upper seat back) and the steel seat base frame. (See red arrows on seat base showing factory holes to line up shield with) (FIG 19) When you re-install the plastic panel you will use these holes to keep the shield in place. Use the 6 provided push pins to hold the shield to the metal seat frame. (Circled in red FIG 20)

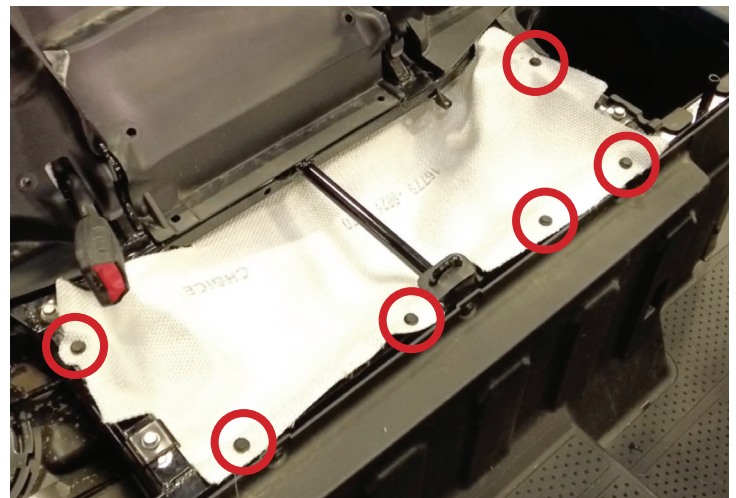

FIG 20

14. Reverse the order to install the remaining parts.